

End of work

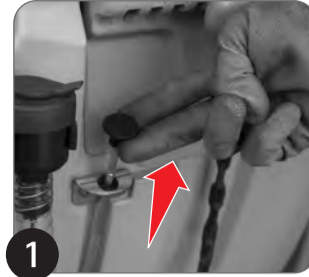

1 Close the tap



2 Lift the washing brush head

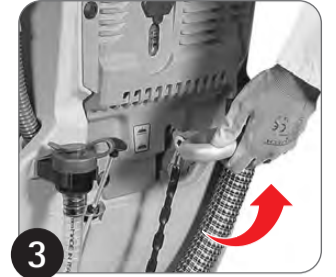

3 Lift the squeegee



4 Switch off the machine

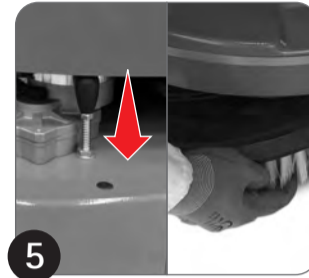

5 Check the wear of the brush or pad



6 If the power level is low, put the machine on charge

Use



1 Fill the machine with solution



2 Start the machine



3 Lower the washing brush head

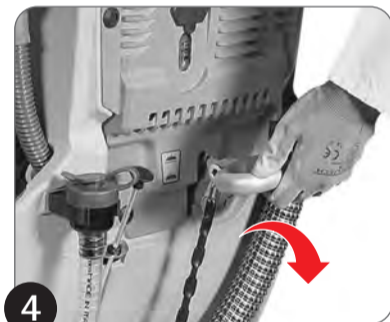

4 Lower the squeegee

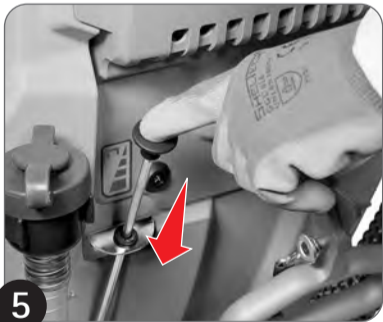

5 Adjust the solution flow



6 Adjust the amount of water and cleaning chemical (CDS version only)



7 Adjust speed

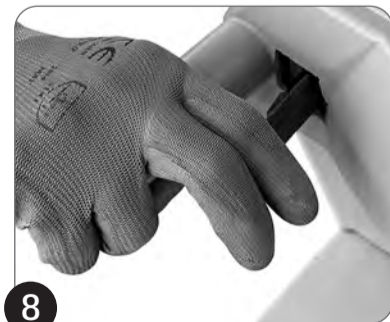

8 Activate the brush/traction command

Daily maintenance



1 Empty the recovery tank



2 Clean the recovery tank



3 Check the condition of the float and the vacuum filter

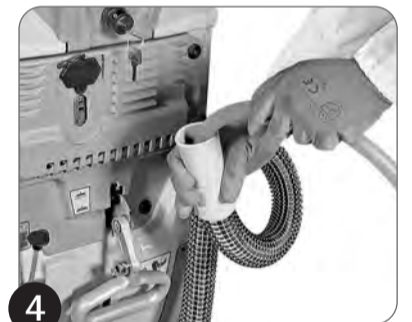

4 Clean the vacuum duct



5 Clean the squeegee



6 Clean the vacuum filter

Troubleshooting

- **The machine will not start:** check battery connections, check the position of the emergency push button, check the position of the key switch, check that the battery charger cable is unplugged.
- **The machine will not move:** check that the electric brake is off, check that the potentiometer is not fully turned to the left (position 0), check that the command levers have been fully pressed down.
- **The brush does not turn:** check that the brush head is lowered, check that the battery is not flat, check that the command levers have been fully pressed down.
- **The machine will not wash:** check the wear of the brush/disc, check the level of the solution in the tank, check that the tap is open, check that the solution filter is clean.
- **The machine will not vacuum:** check that the squeegee is lowered, check that the vacuum and squeegee ducts are clean, check the wear of the rubber blade and if necessary turn, check the correct positioning of the carter and the vacuum hose, check that the recovery tank outlet cap is closed.
- **The battery charger is not charging the batteries:** check the battery connector, check that the power cord is connected, try using another power outlet, if you see flashes, read the battery charger manual.

ATTENTION: before use, disconnect the battery charger and check the level of solution.

ATTENTION: the machine doesn't work in reverse if the squeegee is lowered.