

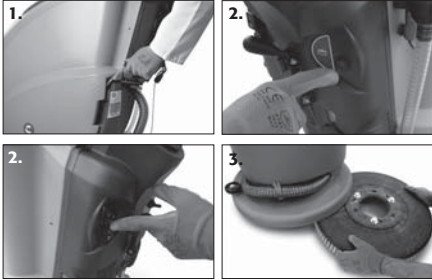

## AT THE END OF THE WORK



1. **Close the water tap**
2. **Lift the brushes and squeegee**
3. **Turn off the machine pressing the ON/OFF switch**
4. **Check the wear of the brushes or discs**  
(to be replaced before the pad holder is being damaged)



**Do not vacuum flammable products such as: alcohol, spirits, trichloroethylene, solvents, etc.**

## DAILY MAINTENANCE

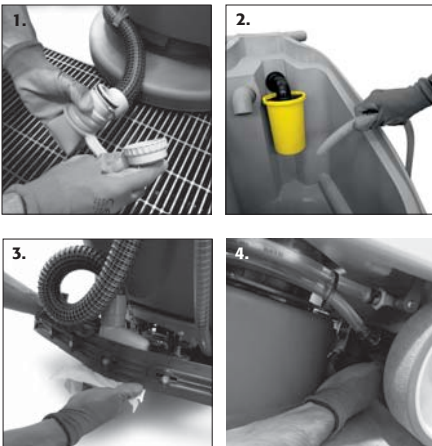

1. **Cleaning the recovery tank**  
Empty the tank using the hose, turning the knob and then removing the cap
2. **Cleaning the recovery tank**  
Open the recovery tank lid and clean the tank with a water jet. Close the cap of the discharge hose and replace it on the machine
3. **Cleaning the squeegee**  
Clean the squeegee with a jet of water and clean the lower part by hand
4. **Cleaning the solution tank filters**  
With the solution tank **empty**:
  1. Unscrew the lid
  2. Remove and clean the cartridge
  3. Open the tap
  4. Rinse the tank with a jet of water.
  5. Reassemble everything, repeating the above-mentioned operations in the reverse order

## WEEKLY MAINTENANCE



1. **Rear squeegee rubber**  
(if worn, change the dryer side; replace after all sides are worn)
- 2.-3. **Cleaning the suction motor filter**  
Extract the suction motor filter and clean it with a jet of water



**You should always wear protective gloves to avoid the risk of serious injury to hands**

## ADJUSTING THE SQUEEGEE

Follow the manufacturer's instructions