

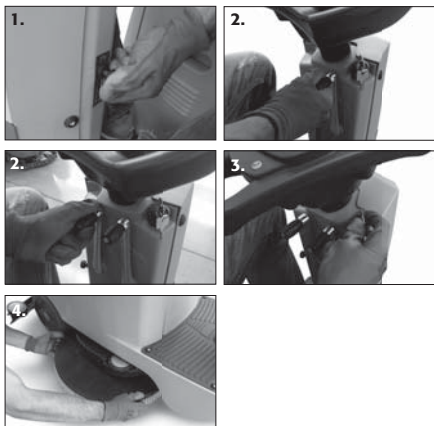

Principle maintenance rules Innova 55

AT THE END OF THE WORK



1. **Close the water tap**
2. **Lift the brushes and squeegee**
3. **Turn the key to the OFF position**
4. **Check the wear of the brushes or discs**
(to be replaced before the pad holder is being damaged)



Do not vacuum flammable products such as: alcohol, spirits, trichloroethylene, solvents, etc.

DAILY MAINTENANCE

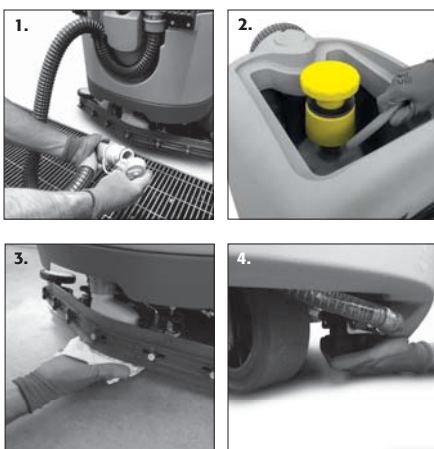

1. **Cleaning the recovery tank**
Empty the tank using the hose, turning the knob and then removing the cap
2. **Cleaning the recovery tank**
Open the recovery tank lid and clean the tank with a water jet. Close the cap of the discharge hose and replace it on the machine
3. **Cleaning the squeegee**
Clean the squeegee with a jet of water and clean the lower part by hand
4. **Cleaning the solution tank filters**
With the solution tank **empty**:
 1. Unscrew the lid
 2. Remove and clean the cartridge
 3. Open the tap
 4. Rinse the tank with a jet of water.
 5. Reassemble everything, repeating the above-mentioned operations in the reverse order

WEEKLY MAINTENANCE

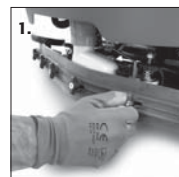

1. **Rear squeegee rubber**
(if worn, change the dryer side; replace after all sides are worn)



You should always wear protective gloves to avoid the risk of serious injury to hands

ADJUSTING THE SQUEEGEE

Follow the manufacturer's instructions