

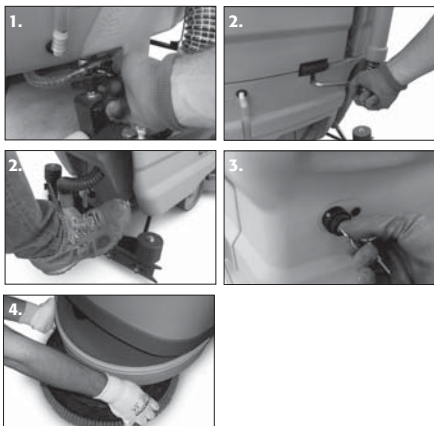

# Principle maintenance rules Abila 45/50/42/52 2010

## AT THE END OF THE WORK



1. Close the water tap
2. Lift the brushes and squeegee
3. Turn the key to the OFF position
4. Check the wear of the brushes or discs  
(to be replaced before the pad holder is being damaged)



**Do not vacuum flammable products such as: alcohol, spirits, trichloroethylene, solvents, etc.**

## DAILY MAINTENANCE

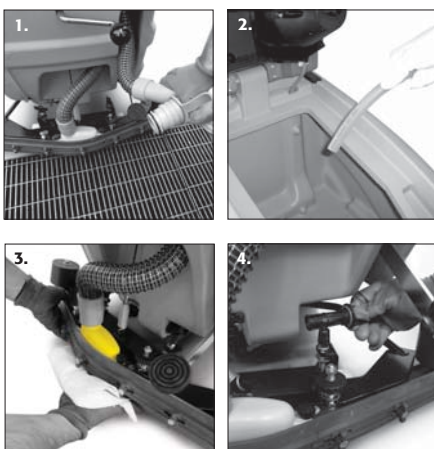

1. **Cleaning the recovery tank**  
Empty the tank using the hose, turning the knob and then removing the cap
2. **Cleaning the recovery tank**  
Open the recovery tank lid and clean the tank with a water jet. Close the cap of the discharge hose and replace it on the machine
3. **Cleaning the squeegee**  
Clean the squeegee with a jet of water and clean the lower part by hand
4. **Cleaning the solution tank filters**  
With the solution tank **empty**:
  1. Unscrew the lid
  2. Remove and clean the cartridge
  3. Open the tap
  4. Rinse the tank with a jet of water.
  5. Reassemble everything, repeating the above-mentioned operations in the reverse order

## WEEKLY MAINTENANCE



1. **Rear squeegee rubber**  
(if worn, change the dryer side; replace after all sides are worn)
- 2.-3. **Cleaning the suction motor filter**  
Extract the suction motor filter and clean it with a jet of water



**You should always wear protective gloves to avoid the risk of serious injury to hands**

## ADJUSTING THE SQUEEGEE

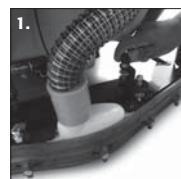

1. Adjust the wheel on the support so that the rubber is not too squashed to the ground, and the squeegee rests evenly on the ground
2. Adjust the inclination using the knob, so that the rubber has on the floor a uniform inclination in both sides and in the centre

## BATTERY MANAGEMENT

Follow the manufacturer's instructions